

# CERTIFICATE OF LOCATION OF GOVERNMENT CORNER

West 1/4 Corner of Section 22, Township 106N, Range 41W, 5th P.M.

STATE OF MINNESOTA, County of Murray

At the corner location shown on the sketch

On 11/09/05 found a 1 1/2" iron pipe 8" deep, removed pipe and excavated below with backhoe. See sheet 2.

left monument as found       lowered monument,       removed monument (explain)

On 11/09/05 placed a 1" iron pipe with red survey cap #43803 at same location as 1 1/2" pipe.

## SKETCH OF REFERENCE TIES

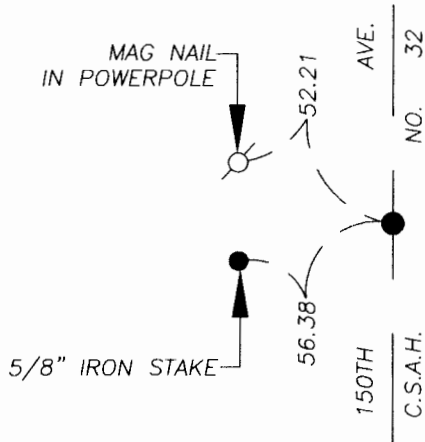
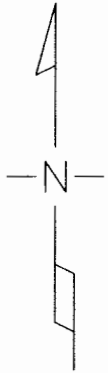

MURRAY CO. COORDINATES  
 NAD 83 (1996 ADJ.)  
 144960.96N  
 500853.49E

I hereby certify that this document and the data contained herein was prepared by me or under my direct supervision.

Dennis Ray Esplan      12/13/05  
 SIGNATURE      DATE

MN. LICENSE NO. 43803

- Land Surveyor,       Professional Engineer  
 County Surveyor,       County Engineer

OFFICE OF THE COUNTY RECORDER

I hereby certify that this document was filed in the Co. Recorder's Office at \_\_\_\_\_ on the

\_\_\_\_\_ day of DEC 14 2005

County Recorder James V. Johnson  
 By \_\_\_\_\_, Deputy

DOCUMENT NO. \_\_\_\_\_

**Statement of Evidence**

**Original Township Subdivision was surveyed by L.G.M. Fletcher in 1861.**

**Murray Co. Hwy. Dept. records indicate a cedar post was set in 1897.**

**November 2005**

**Greg Zieske and Brad Chester with Zieske Land Surveying, Inc. excavated with a backhoe and found 1 1/2" pipe 8" deep on road centerline, removed pipe and excavated below and found a drain tile running north and south down the centerline of road, any monument that may have been below the pipe would have been destroyed when tile was installed. Placed 1" iron pipe with red survey cap at same location as the 1 1/2" iron pipe.**

